

SAE-AS27646

ADOPTION NOTICE

SAE-AS27646, "Bearings, Ball, Airframe, Anti-friction, Extra Light Duty," was adopted on 23 July 1998, for use by the Department of Defense (DoD). Proposed changes by DoD activities must be submitted to the DoD Adopting Activity: Commander, Naval Air Warfare Center Aircraft Division, Code 414100B120-3, Highway 547, Lakehurst, NJ 08733-5100. DoD activities may obtain copies of this standard from the Standardization Document Order Desk, 700 Robbins Avenue, Building 4D, Philadelphia, PA 19111-5094. The private sector and other government agencies may purchase copies from SAE, 400 Commonwealth Drive, Warrendale, PA 15096-0001.

SAE-AS27646 should be used instead of MS27646F, which was inactivated on 23 July 1998.

Custodians:

Army - AV
Navy - AS
Air Force - 99

Adopting Activity

Navy - AS
(Project 3110-1090)

Review Activities:

Army - AR, AT, MI
Navy - SH
Air Force - 84
DLA - GS

AMSC N/A

FSC 3110

DISTRIBUTION STATEMENT A. Approved for public release; distribution is unlimited.

Submitted for recognition as an American National Standard

Form Approved
OMB No. 0704-0188**AS27646****NOTICE**

THIS DOCUMENT HAS BEEN TAKEN DIRECTLY FROM U.S. MILITARY SPECIFICATION MS27646F AND CONTAINS ONLY MINOR EDITORIAL AND FORMAT CHANGES REQUIRED TO BRING IT INTO CONFORMANCE WITH THE PUBLISHING REQUIREMENTS OF SAE TECHNICAL STANDARDS. THE INITIAL RELEASE OF THIS DOCUMENT IS INTENDED TO REPLACE MS27646F. ANY PART NUMBERS ESTABLISHED BY THE ORIGINAL SPECIFICATION REMAIN UNCHANGED.

THE ORIGINAL MILITARY SPECIFICATION WAS ADOPTED AS AN SAE STANDARD UNDER THE PROVISIONS OF THE SAE TECHNICAL STANDARDS BOARD (TSB) RULES AND REGULATIONS (TSB 001) PERTAINING TO ACCELERATED ADOPTION OF GOVERNMENT SPECIFICATIONS AND STANDARDS. TSB RULES PROVIDE FOR (A) THE PUBLICATION OF PORTIONS OF UNREVISED GOVERNMENT SPECIFICATIONS AND STANDARDS WITHOUT CONSENSUS VOTING AT THE SAE COMMITTEE LEVEL, AND (B) THE USE OF THE EXISTING GOVERNMENT SPECIFICATION OR STANDARD FORMAT.

ANY MATERIAL RELATING TO QUALIFIED PRODUCT LISTS HAS NOT BEEN ADOPTED BY SAE. THIS MATERIAL WAS PART OF THE ORIGINAL MILITARY SPECIFICATION AND IS REPRINTED HERE FOR HISTORIC REFERENCE ONLY.

ISSUED 1998-04

PREPARED BY AIRFRAME CONTROL BEARINGS GROUP (ACBG)

SAE The Engineering Society
For Advancing Mobility
Land Sea Air and Space
INTERNATIONAL
400 Commonwealth Drive, Warrendale, PA 15096-0001

AEROSPACE STANDARD

BEARING, BALL, AIRFRAME,
ANTI-FRICTION, EXTRA LIGHT DUTY

AS27646
SHEET 1 OF 3

SAE Technical Standards Board Rules provide that: "This report is published by SAE to advance the state of technical and engineering sciences. The use of this report is entirely voluntary, and its applicability and suitability for any particular use, including any patent infringement arising therefrom, is the sole responsibility of the user."

SAE reviews each technical report at least every five years at which time it may be reaffirmed, revised, or cancelled. SAE invites your written comments and suggestions.

Copyright 1998 Society of Automotive Engineers, Inc.
All rights reserved.

Printed in the U.S.A.

QUESTIONS REGARDING THIS DOCUMENT:
TO PLACE A DOCUMENT ORDER:

(724) 772-8510
(724) 776-4970

FAX: (724) 776-0243

Distributed under license from the IHS Archive

SAE WEB ADDRESS: <http://www.sae.org>

AS27646

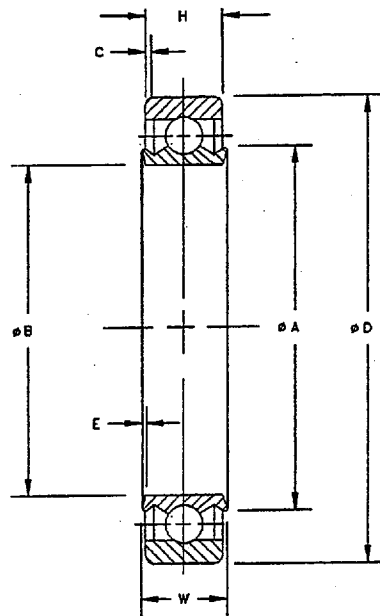

FIGURE 1 BEARING

TABLE I. DIMENSIONS AND LOADS

MS DASH NO.	øB	øD	W	H	øA	E & C	RADIAL LIMIT LOAD RATING LBS	THRUST LIMIT LOAD RATING LBS	4/ 5/ RADIAL LOAD RATING (LBS.) FOR AVERAGE LIFE OF 10,000 COMPLETE 90° CYCLES		WEIGHT POUNDS (APPROX)	MAXIMUM STARTING TORQUE (INCH-OZ)
	5/ BORE	1/ 5/ OUTSIDE DIAMETER	1/ WIDTH INNER RING	1/ WIDTH OUTER RING	SHOULDER DIAMETER INNER RING APPROX.	CORNER CHAMFER X 45°			2/ 3/ LOAD RATING LBS			
	+0.0007 -0.0007	+0.0000 -0.0010	+0.000 -0.005	+0.000 -0.005								
-38	.6250	1.0625	.281	.250	.777	.015	3280	1500	1990	1820	.03	2
-39	.7500	1.1875			.895		3750	1700	2050	1900	.04	2
-40	.8750	1.3125			1.016		4220	1900	2110	1970	.05	3
-41	1.0625	1.5000			1.216		5000	2200	2170	2020	.06	4
-42	1.3125	1.7500			1.451		5950	2700	2220	2130	.09	4
-43	1.5625	2.0000			1.702		6880	3200	2260	2180	.10	5
-44	1.8125 8/	2.2500 7/			1.970		7980	3600	2300	2220	.11	5
-45	2.0625 8/	2.6250 7/			2.286		9220	4000	2340	2260	.15	6
-46	2.3125 8/	2.8750 7/			2.527		10150	4400	2360	2280	.17	6

1/ DIMENSIONS TO BE MET AFTER PLATING.

2/ A RADIUS GIVING APPROXIMATELY THE SAME GRIP FOR STAKING THE BEARING IN THE HOUSING WILL BE ACCEPTABLE.

3/ A RADIUS GIVING APPROXIMATELY THE SAME FILLET CLEARANCE WILL BE ACCEPTABLE.

4/ CASE I = LOAD FIXED WITH RESPECT TO OUTER RING.

CASE II = LOAD FIXED WITH RESPECT TO THE INNER RING.

5/ THESE RATINGS ARE FOR OPERATION UP TO 250°F. WHEN SUBJECT TO OPERATION UP TO 350°F, THE RATINGS SHALL BE REDUCED BY 20 PERCENT.

6/ OUT-OF-ROUND TOLERANCES: BORE: -38 THRU -43 ± 0.0010 ; -44 THRU -46: ± 0.0016 OUTSIDE DIAMETER: -38 THRU -43 ± 0.0005 , -0.0015 ; -44 THRU -46: ± 0.0008 , -0.0023 7/ FOR DASH NUMBER SIZES -44, -45, AND -46, THE OUTSIDE DIAMETER TOLERANCE SHALL BE ± 0.0000 TO -0.0015 INCHES.8/ FOR DASH NUMBER SIZES -44, -45, AND -46 THE BORE TOLERANCE SHALL BE ± 0.0010 TO -0.0010 INCHES.

(F) DENOTES CHANGES